

Dash	A	B	C	D	Element/Curve
1	4	6	12	.187	2252 Ohm J
2	4	6	12	.187	5000 Ohm J
3	4	6	12	.187	10000 Ohm J
4	6	4	36	.187	50000 Ohm J

LTR	DESCRIPTION	BY	DATE

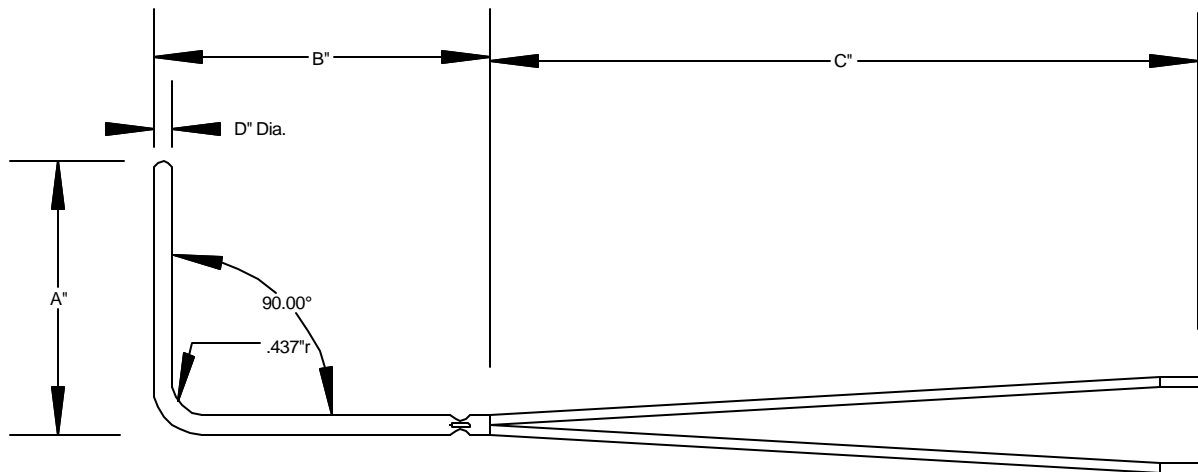

ELEMENT:

Thermistor Type - NTC

Thermal Time Constant: 1 sec max in well stirred oil
or 10 seconds in air.

Dissipation Constant: 1mW/°C

Maximum Power Rating: 30mW/°C derated to 1mW at 125°C

Operating Temperature: -80°C to 150°C

Construction:

Strain Relief: Four point crimp with epoxy end seal.

Sheath: Stainless Steel type 300.

Wire: 22AWG stranded teflon.

--- TOLERANCES UNLESS OTHERWISE SPECIFIED ---

SHEATH LENGTH +/- .100

LEAD LENGTH +/- .25 OR 2% WHICHEVER IS GREATER

WIRE STRIP +/- .125

Drawn	JJB
Approved	
Date	05-13-02
Scale	NA

 <small>TRENTON, NEW JERSEY</small>	
<h1>RIGHT ANGLE</h1>	

Features/Model	
Drawing Number	Revision
<h1>223-40192</h1>	